

TOOLS REQUIRED

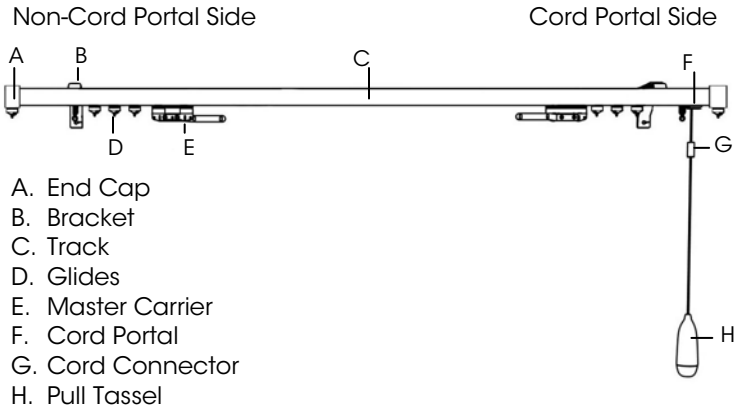

SHORTENING THE SYSTEM - Center Draw

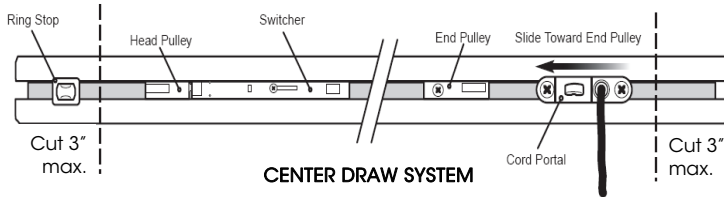

A center draw system may be cut down a maximum of 3" on each side, for a total of 6". The track **must** be cut down **equally from both sides** to keep master carriers centered.

SHORTENING THE SYSTEM- One-way draw

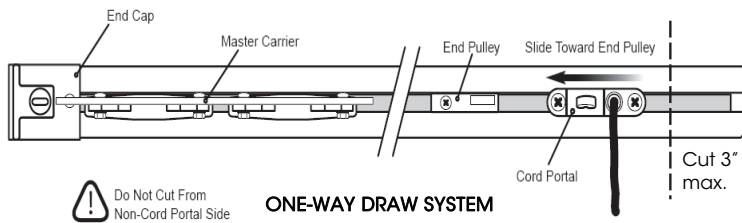

A one-way draw system may be cut down a maximum of 3" from the **cord portal side only**. There are two master carriers on the one-way system. This is to provide a place to hold a ring. The distance between the master carriers is adjustable by repositioning the master carrier overlap bar using the predrilled holes.

Please note! The internal parts of the EasyPull system must not be tampered with. If the internal cords are cut or damaged, the system will not function and must be returned to the manufacturer for repair.

INSTALLATION INSTRUCTIONS

1. BRACKET INSTALLATION

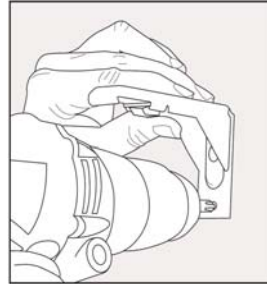

Using a level, install the brackets to the wall with the screws and anchors provided. The anchors provided may need to be replaced with heavier-duty anchors depending on the fabric and treatment weight.

2. TRACK INSTALLATION

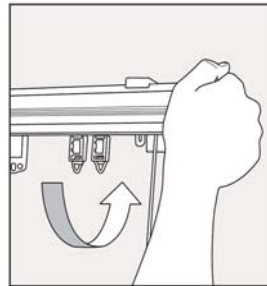

Snap the track into the brackets by placing the front lip of the track under the front edge of the bracket then pushing the back lip of the track up and into the plastic spring-tension clip. Push until you hear a "click" to know that the track is snapped securely in place. For a double track system the back track clips in exactly opposite.

3. ADDING FASCIA

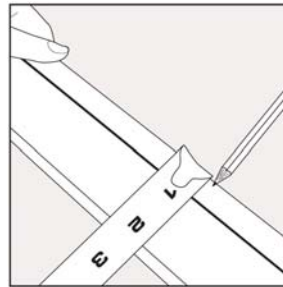

Measure and mark the back of the pole fascia for proper fascia track clip placement. For 2 1/4" poles, place mark 1/2" down from top of pole. For 2" poles, place mark 1/4" down from top.

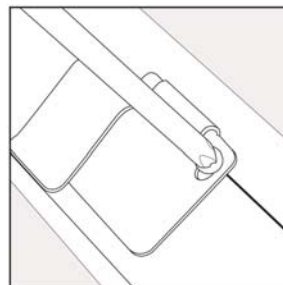

Attach the fascia track clips with the screws provided.

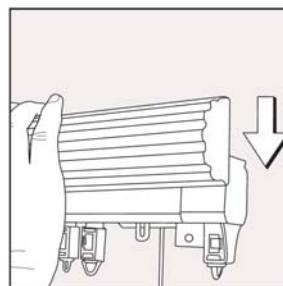

Slide pole fascia onto track.

4. ADDING AND REMOVING RINGS FROM GLIDES

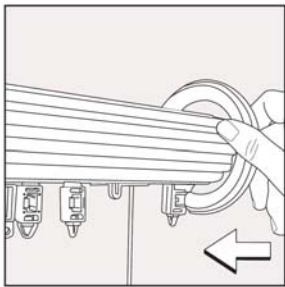

For traverse systems with rings, install rings into ring glides, master carriers, and end caps by pushing the ring in until you hear a snap, or until ring is snug.

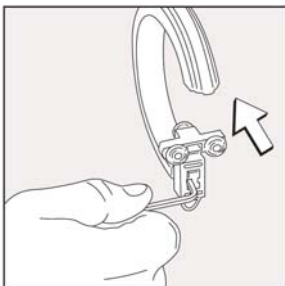

A ring removal tool is included in the packaging. Take system down from brackets to make the back of track accessible for easier ring removal. Place ring tool in the hole beside the tab and lever toward the center. This will push tab to the left and push ring forward out of glide.

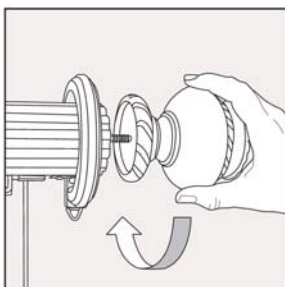

Install finials.

ADDING AND REMOVING GLIDES

Glides must be added and/or removed in equal numbers from each side of rod, except on a one-way draw.

On cord portal side: Remove finial and loosen screw on end cap and remove. Loosen the two cord portal screws and gently slide portal out of rod end. Add or remove glides as needed. Slide cord portal back into rod keeping cord pull closest to end of rod. Replace end cap and tighten screw. Be sure to tighten cord portal screws once all components are in their proper positions.

On non-cord portal side: Loosen screw and remove end cap. Remove ring stop. Add or remove glides as needed. Replace ring stop and end cap. Replace end cap and tighten screw.

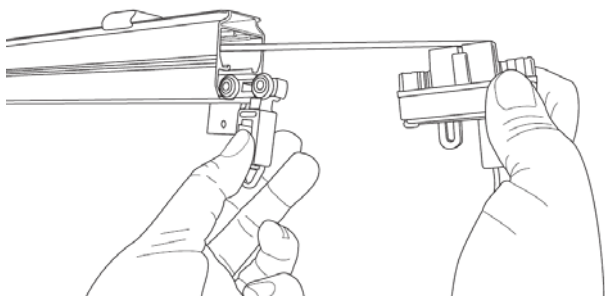

5. CONNECTING THE PULL TASSEL

Slide back the cord connector cover (A) and position the knotted end of the pull cord as shown. Re-position the connector cover to secure the pull cord in place. To lengthen the pull cord, pull apart the tassel (B) and feed out the excess cord. When at the required length, tie a knot, then reassemble the tassel.

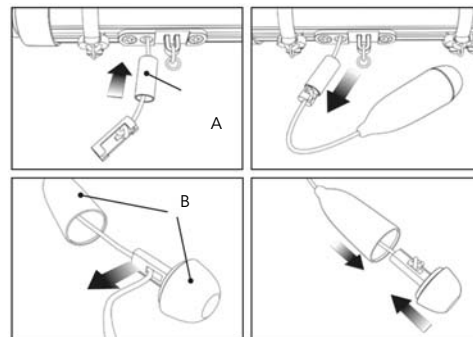

DOUBLE SYSTEM NOTE

The back pole fascia for a double rod system will be a thinner section of pole fascia connected by Velcro. The back track end cap finial may be attached by screwing it directly into the plastic track end cap (hole will be pre-drilled).

SPliced TRACKS

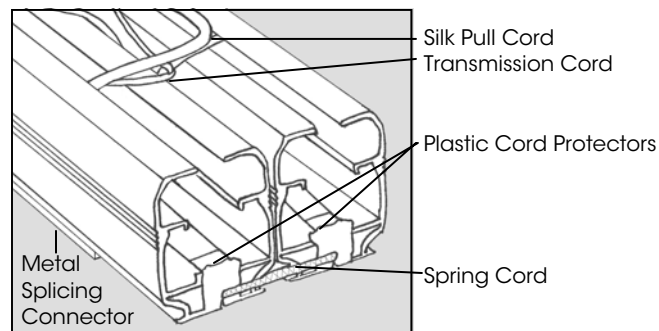

1. Remove track from packaging
2. Remove plastic cord protectors and all masking tape from pulley cords.
3. Add metal splicing connector to one side of track.
4. Unfold end-to-end while guiding silk pull and transmission cords back into the track.
5. Slide splicing connector over the spliced seam

Note: Gently remove the masking tape while being careful not to allow the cords to become frayed on the cut track edges.

OPERATING THE SYSTEM

Once the track is installed, the system can be operated in 3 simple steps:

1. TO CLOSE - pull the tassel downwards to move master carriers toward the center. If the master carriers don't fully meet in the center, gently pump the cord up and down without fully retracting the cord into resting position until master carriers meet. (Fully retracting the cord causes the master carriers to change direction.)
2. Allow the pull cord to fully retract, ready for opening.
IMPORTANT - Never let go of the pull cord during the open or close operation as the system is under a spring loaded tension.
3. TO OPEN - Repeat step 1.